

# ASSEMBLY INSTRUCTION

## H19745R TABLE LAMP

No special tools are needed to install this table lamp. Be sure to follow the steps in assembly instruction given. If you are unclear for how to proceed, consult a qualified electrician.

### IMPORTANT SAFETY INSTRUCTION

- To prevent shock, only plug in unit after completed assembly.
  - Do not exceed the maximum wattage rating as suggested.
  - Before switch on the lamp, please follow the instruction step by step.
- Note : Never use with an extension cord unless plug can be fully inserted.  
Do not modify or change from original lamp plug to fit to different outlet.

- Step 1:  
Take out the lamp from the package slowly.
- Step 2:  
Place the lamp on the smooth and stable table/desk top.
- Step 3:  
Insert the plug to the proper outlet. Switch to turn on or off the lamp.

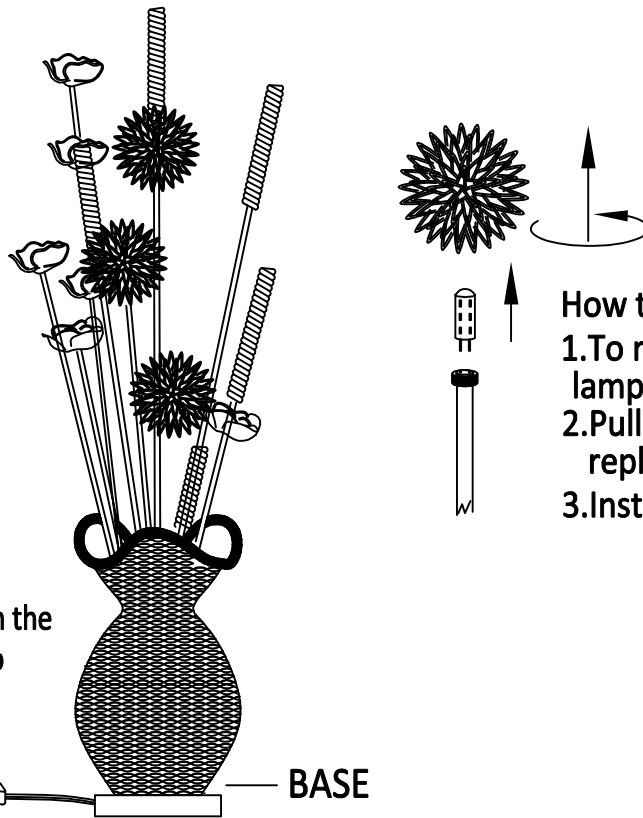

### Seesaw switch

(Press on one side to turn on the lamp, press the other way to turn off the lamp.)

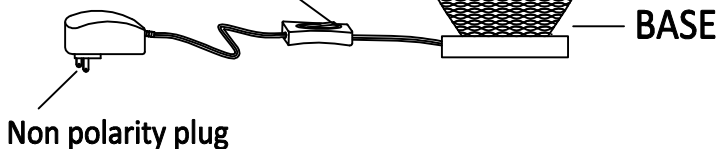

### How to replace the light bulb :

- 1.To release the lampshade,rotate the lampshade counter clockwise.
- 2.Pull out the bulb and replace it with a new one.
- 3.Install the lamp shade back.

## Care Instruction

To clean the lamp, wipe with a soft cloth. Do not use abrasive materials such as chemical pad, paper or cleaner.